



Mounts at any angle



Available in grommet,
surface, and flange mount

TecNiq's New Combination Stop/Tail/Turn/Reverse

Introducing TecNiq's new 6" oval LED stop/tail/turn with integrated reverse light. By bringing the four functions together in one light, our customers will save on installation and product costs including inventory and shipping expense.

- Fits all standard 6" oval applications
- Combines standard stop/tail/turn functionalities with reverse light into one 6" oval
- 360° optics allow lights to be mounted at any angle
- High intensity function only draws 0.14A at 12VDC
- Reverse function uses an additional 0.30A
- Lifetime Warranty

Our new T70 Stop/Tail/Turn/Reverse light will save you time and money. Please contact us for your product demonstration.

All of our T70 tail lights are designed
and manufactured at our Richland, MI facility



Grommet Mount

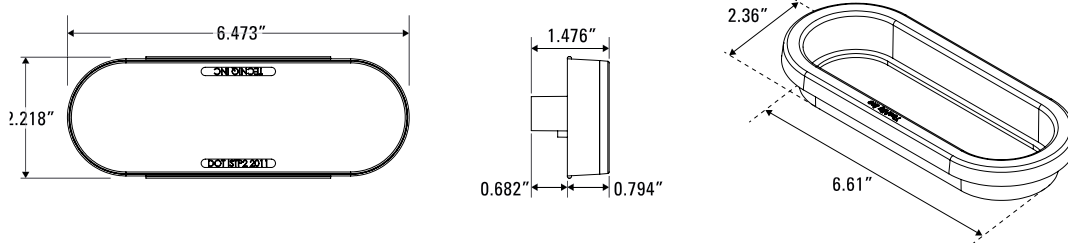

Flange Mount

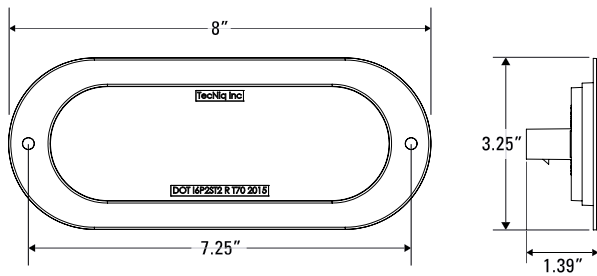

Surface Mount

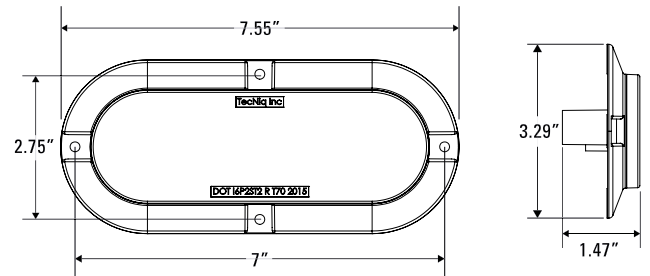

*Patent Pending

Model	Part Number	Connector	Dimensions	Max Amp Draw
Combination S/T/T/R Grommet Mount	T70-RW0A-1	2 Amp	6.47" x 2.22" x 1.48"	0.41A - 0.50A
	T70-RW0P-1	2 Pigtail		
	T70-RW0T-1	2 Tri Pole		
Combination S/T/T/R Flange Mount	T70-RWFA-1	2 Amp	8.00" x 3.25" x 1.39"	
	T70-RWFP-1	2 Pigtail		
	T70-RWFT-1	2 Tri Pole		
Combination S/T/T/R Surface Mount	T70-RWSA-1	2 Amp	7.55" x 3.29" x 1.47"	
	T70-RWSP-1	2 Pigtail		
	T70-RWST-1	2 Tri Pole		

For more information on the newest addition to TecNiq's industry leading lighting solutions, visit www.TecNiqInc.com or call us at (269) 629-4440.