

Incorporating a new ultra-efficient lens design, our license lamps provide bright, even illumination that exceeds government requirements. The **L12** model is designed to meet DOT requirements for applications where the license lamp is recessed in relation to the mounting point. Screw holes are intended for mounting on a plane perpendicular to the license plate. Available in either black or chrome finish.

See www.TecNiqInc.com for more details and a complete list of part numbers.



L12

**DOT RATED
LICENSE LAMP**

Technical features

- ✦ SAE DOT rated
- ✦ TecSeal Urethane Potting - Guaranteed Circuit Board Protection
- ✦ Durable impact resistant lens
- ✦ Easily mounts using just two screws
- ✦ Available in our black or chrome finish

Specifications

Dimensions:	2.6" x 1" x 0.78"
LEDs:	1
Voltage:	9 - 14V DC
Current:	0.06A-0.11A
Connector:	9" Pigtail or 9" wire w/0.180" bullet
Mounting:	Surface mount using just (2) screws

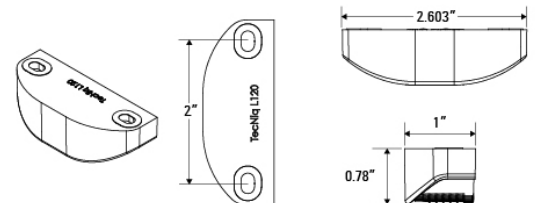

California Proposition 65

WARNING: This product can expose you to chemicals including lead, which is known to the State of California to cause cancer, birth defects or other reproductive harm

Part Numbers	Description	Std	Connector
L12-WB00-1	Black Base License Lamp Horizontal Plane Mount	1	Sheathed Pigtail
L12-WB5B-1	Black Base License Lamp Horizontal Plane Mount w/.180" Bullets	1	0.180" Bullets
L12-WB8B-1	Black Base License Lamp Horizontal Plane Mount 18" Lead W/.180 Bullet	1	0.180" Bullets
L12-WC00-1	Chrome Base License Lamp Horizontal Plane Mount	1	Sheathed Pigtail

